



Communication for All How to Guide: Grid for iPad

An Overview of Grid for iPad

This is Super Core 30, a symbol based, core vocabulary grid set. The grid is divided into cells, and each cell has a word and a symbol. The information below is relevant for other types of grid sets including Supercore 50 and Vocochat.

Command cells

Sentence strip

Vocabulary cell

Command cells

magic wand	jump back	I want to go	speak	clear
I	be	want	see	now
it	go	stop	good	in
you	help	like	more	not
people	questions	actions	describe	little words
+	+	+	+	+

This is the core vocabulary. Some of the words will adjust to make the sentences grammatically correct.

Cells with a small black triangle are called 'jumps'. They will jump you to a new grid with more words or more options.

magic wand	jump back	I want to go	speak	clear
I	be	want	see	now
it	go	stop	good	in
you	help	like	more	not
people	questions	actions	describe	little words
+	+	+	+	+

Edit Mode

Communication for All will turn off Edit Mode when the device is initially transferred to the young person. To edit cells on the device, follow these steps:



Tap the Settings icon to open the iPad settings.

Scroll down the menu on the left and tap Grid

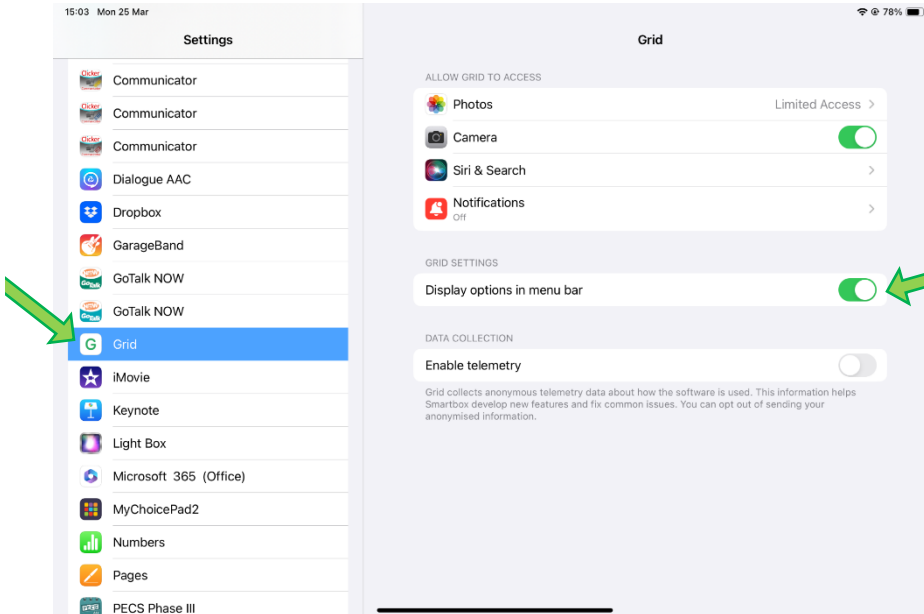

Tap the 'Display options in menu bar' slider to make it green.

Important!!!

Make sure that you are on the page you want to edit before you tap the options menu.

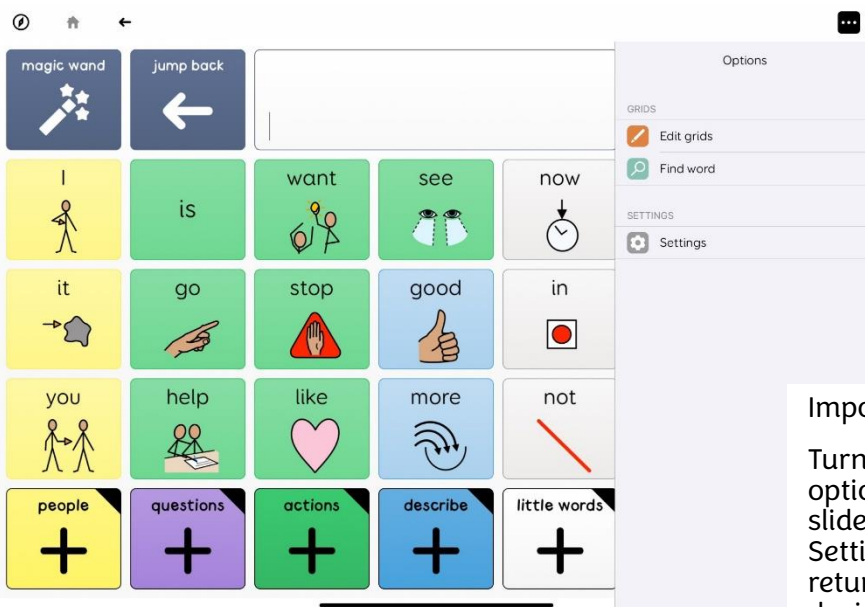

You will now see three dots '...' in the top right corner. Tap these and an options menu will appear.

Important!!!

Turn off the options menu slider in Settings before returning the device to the young person.

Editing Cells

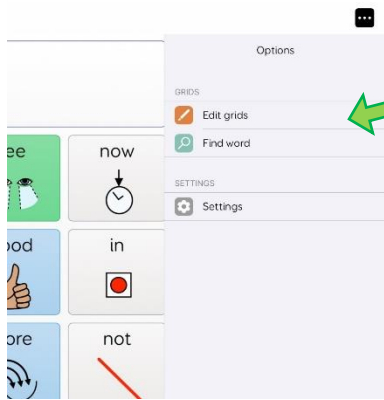

Tap options menu > Edit Grids

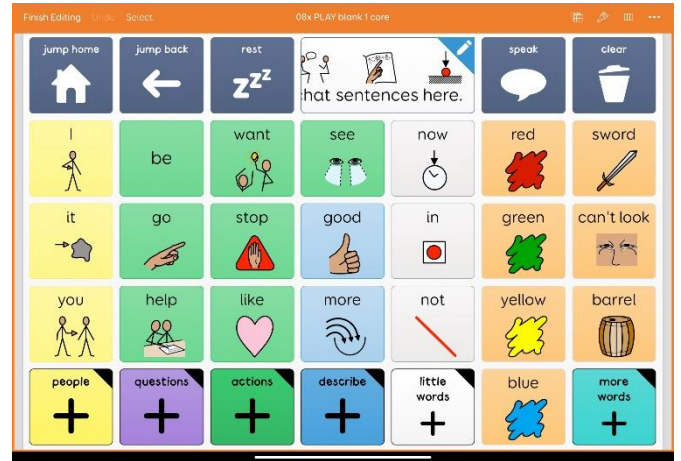

The screen will change slightly to look like this:

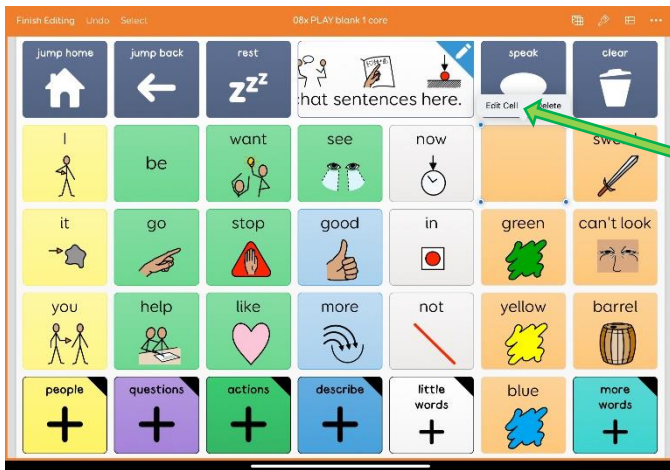

Tap on the cell you wish to edit, then tap 'Edit Cell'

Tap on the top box to type in the word.

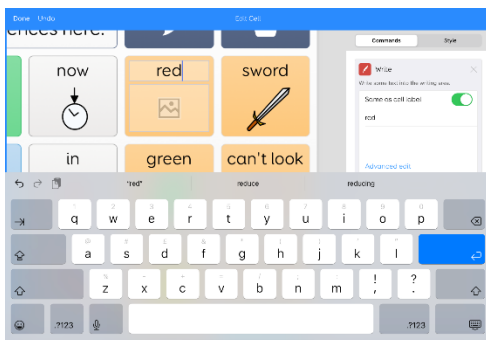

Tap on the bottom box to choose the symbol. You can use suggested symbols, add in photos or remove the picture.

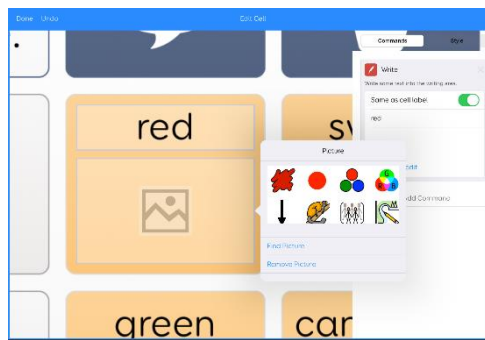

Tap on 'Style' to change the colour of the cell. See the Fitzgerald Key for more information.

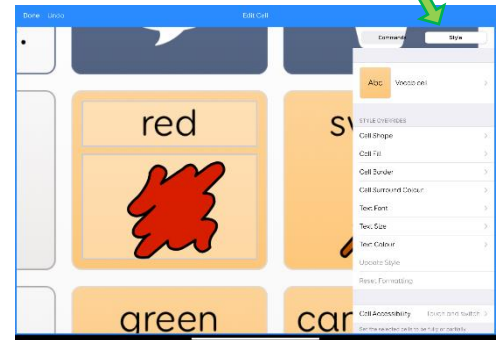

Tap 'Done' in the top left corner, then tap Finish Editing.
Don't forget to turn off Options Menu in Settings when finished

Remote Editing

You can remotely edit Grid for iPad from a Windows device. To do this, you must have Grid 3 installed on the device.

To install Grid 3 on a Windows device (e.g. PC), go to this website:

www.thinksmartbox.com/try-grid/

[Try Grid AAC software by Smartbox \(thinksmartbox.com\)](http://www.thinksmartbox.com/try-grid/)

Click on the 60 day free trial button and follow the onscreen instructions to download the software.



Once the software has downloaded, open Grid 3 and set up a user account. You do not need a Grid 3 licence to remotely edit.

How to Invite a Remote Editor

Tap the compass in the top right of the screen

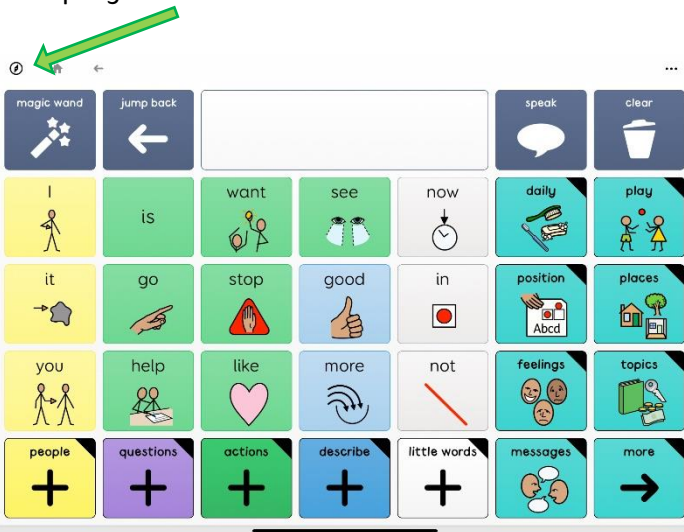

This will take you to the Grid Explorer. Tap the options menu and select 'Settings' and 'Accounts'

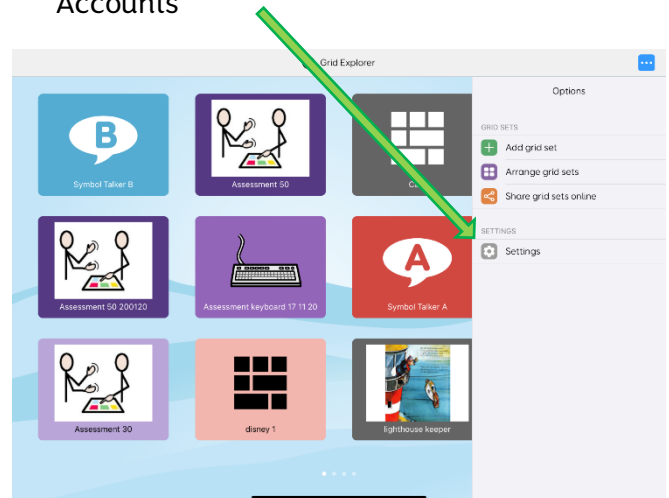

Make sure the device is signed into the Smartbox and Dropbox accounts. Then select Remote Editors

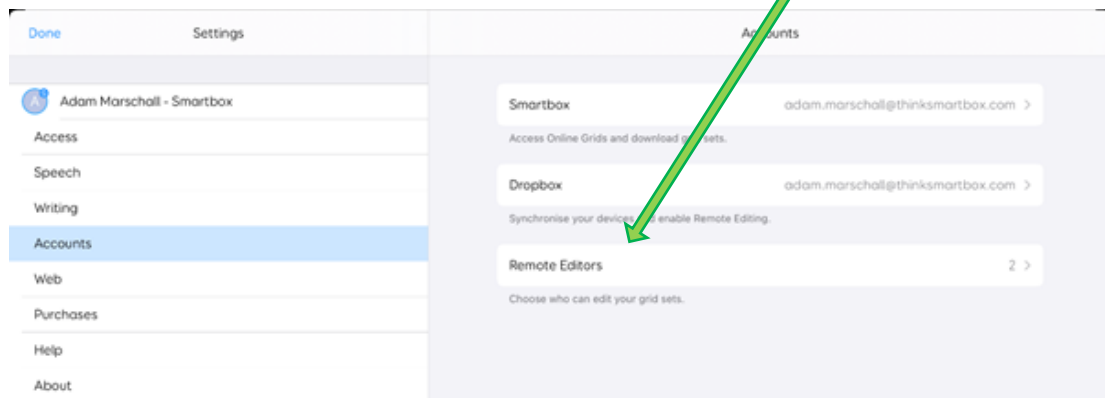

Tap on the + symbol and enter the email address of the remote editor. Press save

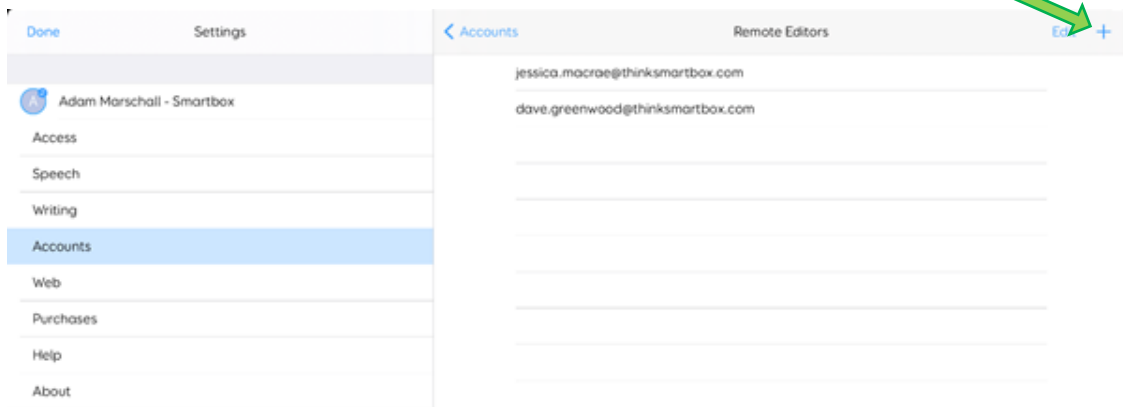

How to Remotely Edit

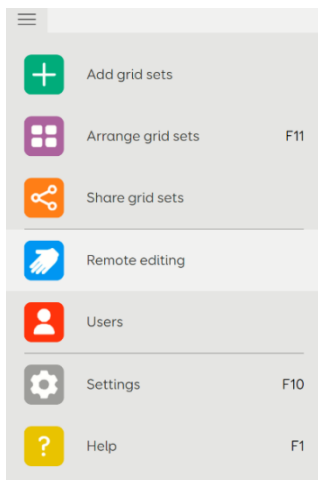

Open Grid 3 on your Windows device. Click on the three lines at the top right of the screen.

Click on 'Remote editing'.

Enter your log in details, you will see the names of the users who have invited you to remotely edit. Select the user you want to edit.

Follow the steps above to edit cells.

Any changes you make will be synced to the device through Dropbox. This may take a little while to sync.

